



40 Huntingwood Drive Huntingwood NSW 2148

Phone: (02) 8825 1999 Website: www.aeroflowperformance.com

INSTALLATION MANUAL

AEROFLOW PERFORMANCE

LS CHEV OIL FILTER ADAPTER

WARNING!

BEFORE PROCEEDING WITH INSTALLATION PLEASE READ INSTRUCTIONS CAREFULLY. THIS PRODUCT REQUIRES DETAILED KNOWLEDGE OF AUTOMOTIVE SYSTEMS. WE RECOMMEND THAT THIS INSTALLATION BE CARRIED OUT BY A QUALIFIED AUTOMOTIVE TECHNICIAN.

INTRODUCTION

Congratulations on your purchase of Aeroflow Performance LS Chev oil filter adapter. Aeroflow Performance products cannot and will not be responsible for any damage, or other conditions resulting from misapplication of the parts described herein. However, it is our intention to provide the best possible products for our customer, products that perform properly and satisfy your expectations. Should you have any questions? Please call technical support at +61 2 8825 1900 and have the product part number on hand when calling.

This product is designed to suit LS Chev engine oil sumps AF82-2016 and AF82-2012 when you wish to run an oil filter in the stock location. The AF82-2022 mounts the oil filter horizontally or at a 90-degree angle. Ensure to check clearance and location when using this oil filter attachment for your application. It may or may not be in a convenient location to access on a regular basis to change the oil filter.

This oil filter block will accept the OEM factory oil filter and also the Aeroflow equivalent AF2296-1017 which is SOLD SEPARATELY.

One 1/8 NPT port is located on the side of this oil filter adapter with a plug to allow auxiliary inputs such as oil pressure sensor etc.

In this kit there are two different length socket cap Allen key bolts. The smaller UHL is 35mm and the longer is 40mm. The shorter bolt is designed to work in the countersunk hole underneath the oil filter. These bolts should be torqued down to 18ft-lb (24Nm). Two new O-rings must be installed and correctly lubricated to ensure they do not pinch when installing. The included oil filter stud should be installed first into the oil filter block adapter and not into the oil filter itself.

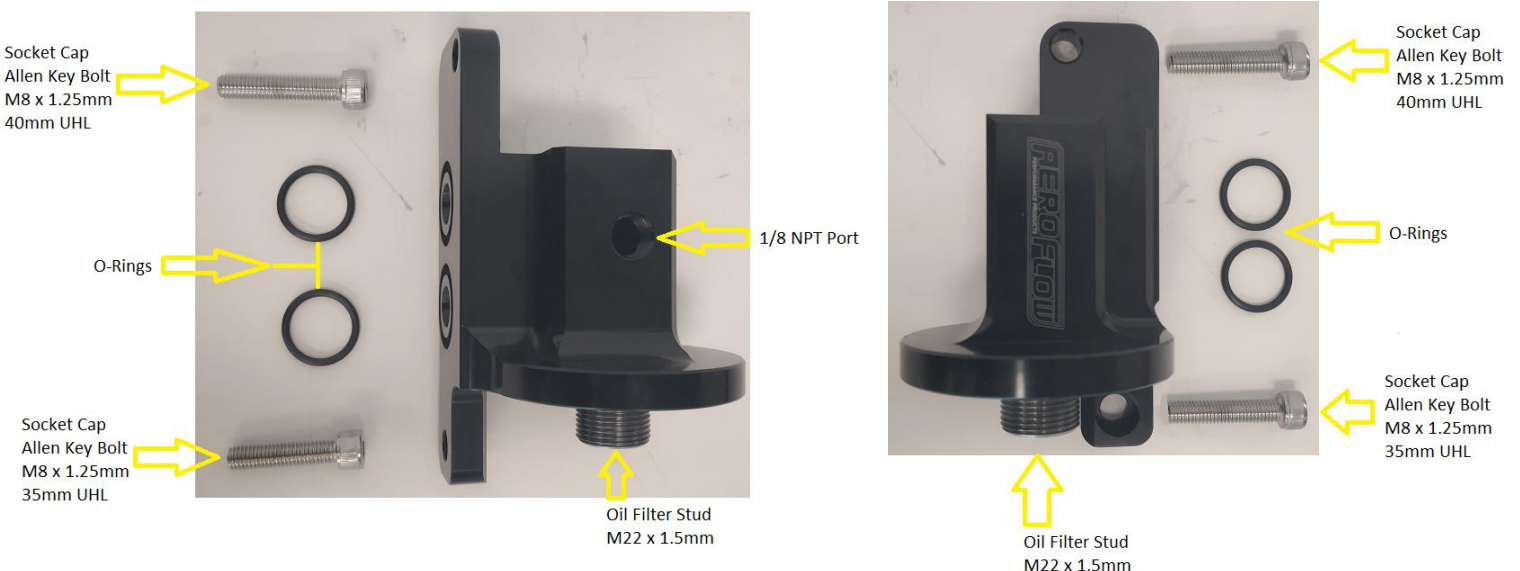

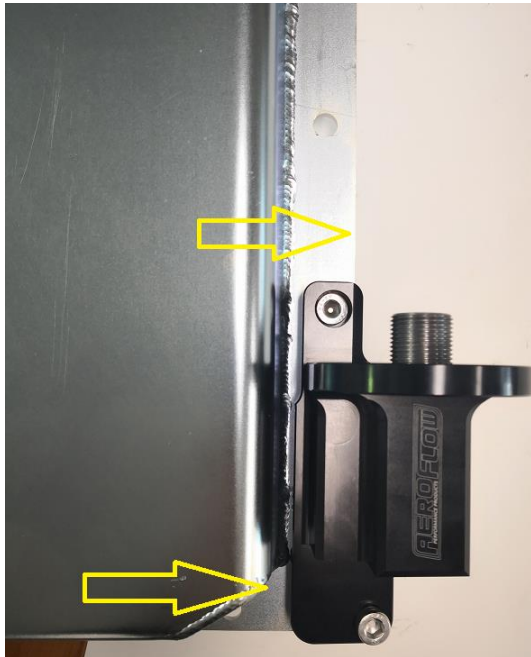
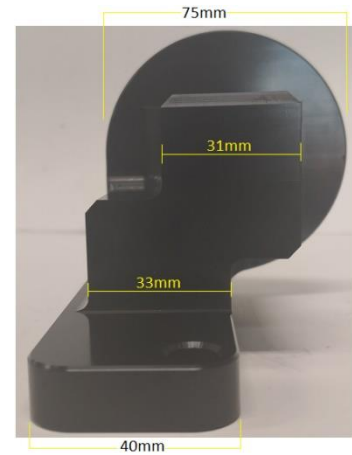
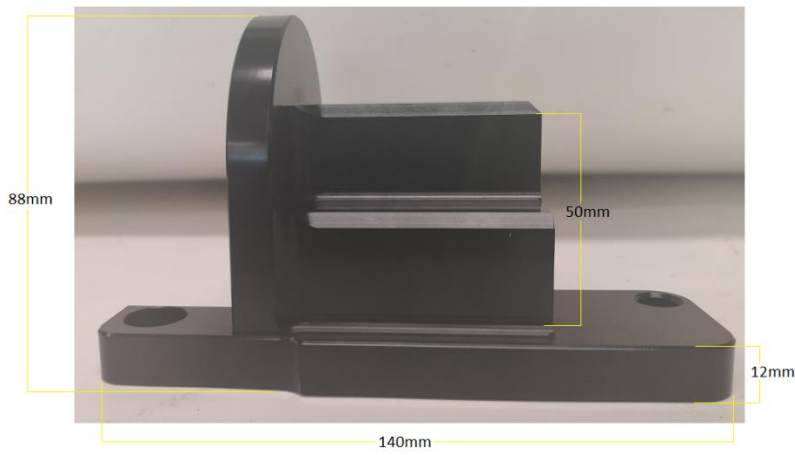

AF82-2016

NOTE: When installing this oil filter block adapter onto the front sump oil pan (pictured) it is recommended to push the adapter away from the pan to ensure a correct seal of both O-rings.

AF82-2012

Pictured is this oil filter block adapter attached to the AF82-2012 rear sump oil pan with an AF2296-1017 oil filter attached



For more information or technical enquires

Contact: Aeroflow Performance on

Phone: (02) 8825 1979 Website: www.aeroflowperformance.com