



AF64-4003 & AF64-4003BLK

Big Block Chevy low mount passenger side alternator bracket kit.

Congratulations on the purchase of your new Aeroflow Performance Product

- 1) Disconnect Battery; remove all existing accessory drive brackets and components from motor. Disconnect all existing power steering lines and cap.
- 2) Clean and prep engine block for installation. Inspect threads in engine block, Run a 7/16" thread cleaners if necessary. Thread cleaners are available at your local auto parts store or tool dealer and are different from a thread cutting tap.
- 3) Loosely assemble alternator bracket by inserting the (2) 7/16-14 x 82mm socket head cap screws through the two middle holes on the front bracket. Place (2) 40mm spacers on both bolts. Thread completed assembly through rear bracket two middle holes and into engine block. Do not tighten at this time
- 4) Thread the (1) 3/8-16 x 75mm socket head cap screw through the top hole in front bracket and place in order (1) 1-3/32" spacer, rose joint assembly then 5/16" spacer. Finish by threading into rear bracket and finger tighten.
- 5) Attach small aluminum ear bracket to back of alternator mount boss with (1) 5/16-18 x 22mm socket head cap screw and tighten (26 ft/lb)
- 6) Place alternator between front and rear brackets, thread (1) 3/8-16 x 70mm socket head cap screw through bottom hole on front bracket, through alternator boss and into rear bracket. Finger tighten.
- 7) Swing alternator up to meet turnbuckle assembly and match up holes to aluminum ear bracket and thread (1) 3/8-16 x 25mm socket head cap screw through rose joint assembly and into aluminum ear bracket and tighten (46 ft/lb)
- 8) Tighten the (2) 7/16-14 x 82mm socket head cap screws into engine block at this time. (46 ft/lb) Also tighten the (1) 3/8-16 x 75mm socket head cap screw at the top of the bracket. (46 ft/lb)
- 9) Route V-Belt over water pump pulley, crank pulley and alternator pulley. Turn rose joint assembly until proper belt tension is achieved. Tighten jam nuts on turn buckle. Tighten alternator 3/8-16 x 70mm socket head cap screw on bottom of bracket at this time. (46 ft/lb) Re-check belt tension.
- 10) Reconnect electrical and test run engine. Re-check belt tension after 100 km's .

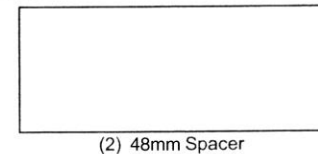
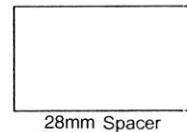
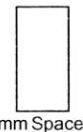
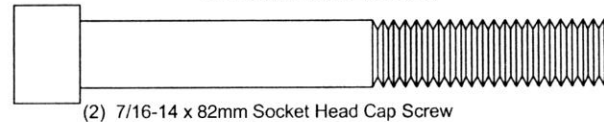
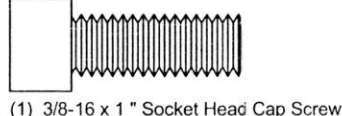
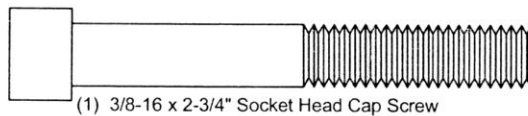
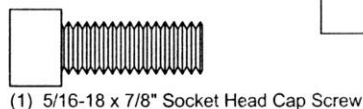
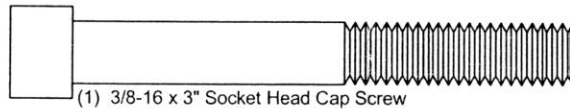
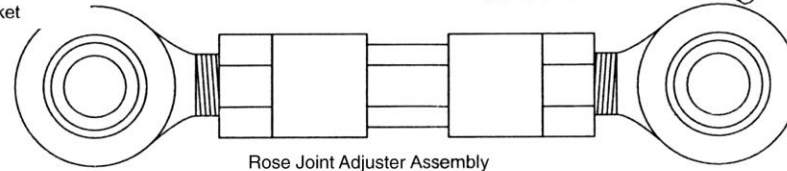
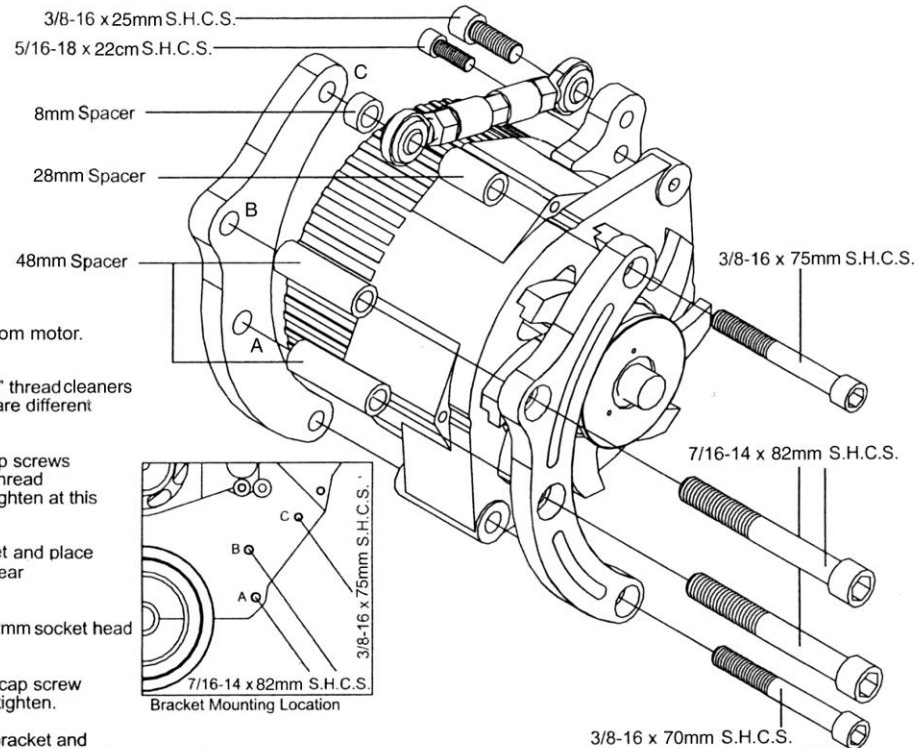

www.aeroflowperformance.com