



40 Huntingwood Drive Huntingwood NSW 2148

Phone: (02) 8825 1999 Website: www.aeroflowperformance.com

INSTALLATION MANUAL

AEROFLOW PERFORMANCE FORD XR6 FG

WARNING!

BEFORE PROCEEDING WITH INSTALLATION PLEASE READ INSTRUCTIONS CAREFULLY. THIS PRODUCT REQUIRES DETAILED KNOWLEDGE OF AUTOMOTIVE SYSTEMS. WE RECOMMEND THAT THIS INSTALLATION BE CARRIED OUT BY A QUALIFIED AUTOMOTIVE TECHNICIAN.

Item list included in this kit:

1x -4AN oil feed line (includes zinc coated steel 90° crimp fitting and zinc coated steel straight crimp fitting with 200 series Teflon braided line)

1x -4AN oil feed line (includes zinc coated steel 90° crimp fitting and zinc coated steel straight crimp fitting with 200 series Teflon braided line and heat sleeve clamped down on one end for protection)

1x Stainless Steel Banjo Fitting to -4AN

1x Stainless steel 7/16 to -4AN fitting

1x -4AN extra olive for adjusting length if required.

1x 40 micron oil filter with -4AN male ends

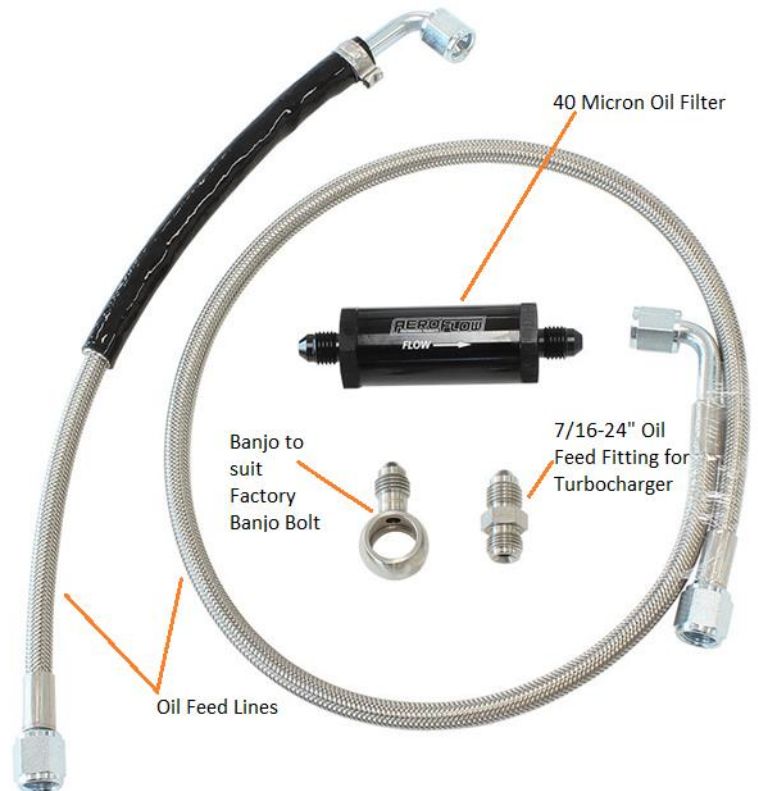

INTRODUCTION

Congratulations on your purchase of Aeroflow Performance Ford XR6 FG turbo feed line. Aeroflow Performance products cannot and will not be responsible for any damage, or other conditions resulting from misapplication of the parts described herein. However, it is our intention to provide the best possible products for our customer, products that perform properly and satisfy your expectations. Should you have any questions? Please call technical support at +61 2 8825 1900 and have the product part number on hand when calling.

This product suits Ford XR6 FG with standard low mount turbo configuration. Below is a basic guideline to fitting this kit.

Note if vehicle is a F6 model requires purchase of AF359-04 which is an M12 x 1.25mm to -4AN.

STEP 1: REMOVAL

1. Following factory service manual to remove the turbo feed line from vehicle.
 - I. Disassemble the turbo feed line from the vehicle.
 - II. Ensure to keep all bolts, spacers, gaskets, stock hard lines as these may be required for reinstallation.

STEP 2: ASSEMBLY

1. Install banjo fitting into engine block using the factory banjo bolt, ensure to use new crush washers supplied.
 - I. NOTE: If F6 model purchase AF359-04 and install into engine block with new crush washers both of which not supplied in this kit.
 - II. Install oil restrictor into -3AN fitting that connects to banjo fitting on top of turbo when installing oil feed line.
 - III. IMPORTANT: ensure to remove the factory oil filter screen located in either the engine block or the factory fitting that is screwed in to the block. This screen can very easily block up and stop oil from flowing to your turbocharger.



2. Install 7/16 fitting into top of turbo
3. Install 40-micron oil filter in-between both -4AN oil feed lines
 - i. Note when installing new braided lines to oil feed and water lines do not overtighten fittings as this will damage them
 - ii. When running braided line across the engine ensure it is away from any direct heat source and does not come into contact with any moving parts.
 - iii. When installing new line ensure line with heat sleeve reattached is installed on the turbo side

STEP 3: REINSTALLATION

1. Following factory service manual reinstall turbo and manifold assembly to vehicle.
2. Start engine and ensure to check for leaks from any fittings or lines before driving vehicle.
3. If no signs of leakage have been found on the final inspection, then the installation is complete.

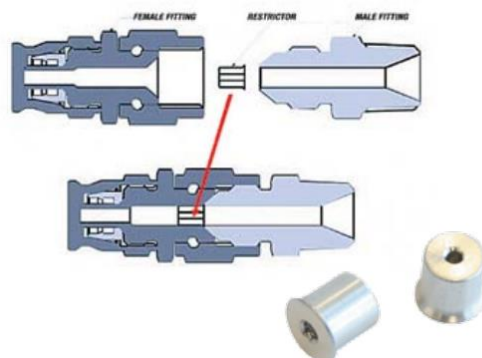

For more information or technical enquires

Contact: Aeroflow Performance on

Phone: (02) 8825 1979 Website: www.aeroflowperformance.com