



40 Huntingwood Drive Huntingwood NSW 2148

Phone: (02) 8825 1999 Website: www.aeroflowperformance.com

INSTALLATION MANUAL

AEROFLOW PERFORMANCE NISSAN SR20 S13

WARNING!

BEFORE PROCEEDING WITH INSTALLATION PLEASE READ INSTRUCTIONS CAREFULLY. THIS PRODUCT REQUIRES DETAILED KNOWLEDGE OF AUTOMOTIVE SYSTEMS. WE RECOMMEND THAT THIS INSTALLATION BE CARRIED OUT BY A QUALIFIED AUTOMOTIVE TECHNICIAN.

Item list included in this kit:

- 1x -3AN oil feed line (includes stainless 90° fitting and stainless straight fitting with 200 series Teflon braided line)
- 1x Stainless Steel Banjo Fitting to -3AN (reuse original Nissan M12x1.25mm Banjo Bolt)
- 1x Stainless Steel 7/16-24 to -3AN
- 1x -3AN extra olive for adjust length if required.
- 1x 1mm oil restrictor to fit -3AN oil feed line
- 1x -6AN coolant line (includes 150 series 90° fitting with 100 series rubber braided line)
- 1x -6AN coolant line (includes 150 series 90° fitting and 150 series straight fitting with 100 series rubber braided line)
- 1x Silver hose hex finisher
- 3x M14 to -6AN fittings
- 6x Aluminium crush washers

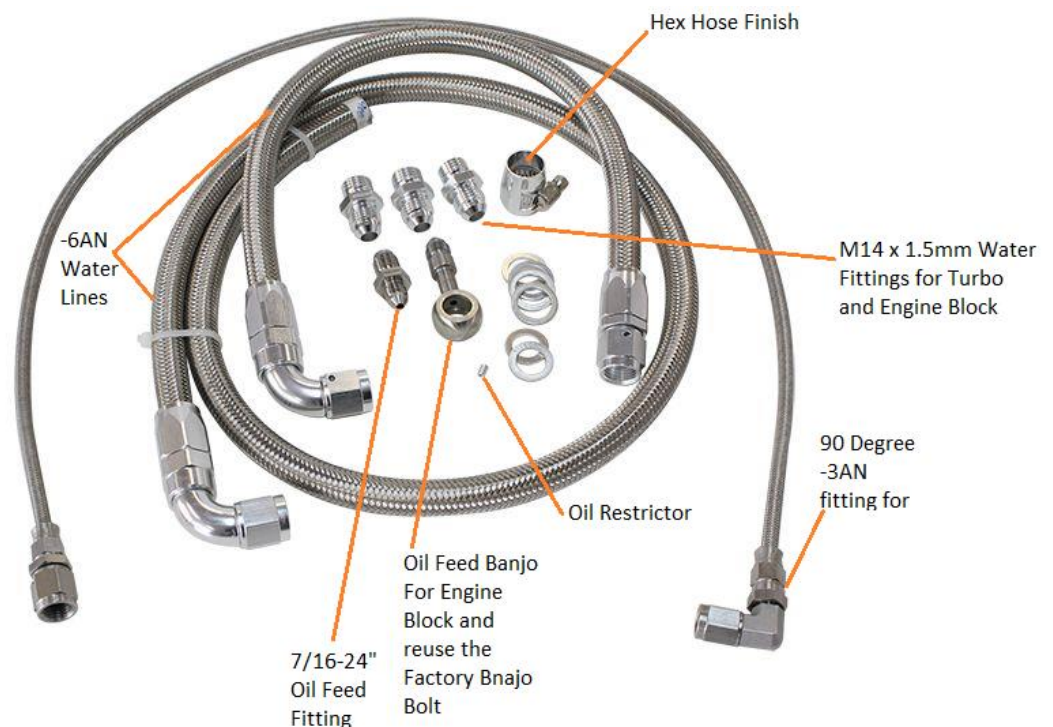

INTRODUCTION

Congratulations on your purchase of Aeroflow Performance Nissan SR20 S13 turbo and water lines. Aeroflow Performance products cannot and will not be responsible for any damage, or other conditions resulting from misapplication of the parts described herein. However, it is our intention to provide the best possible products for our customer, products that perform properly and satisfy your expectations. Should you have any questions? Please call technical support at +61 2 8825 1900 and have the product part number on hand when calling.

This product suits Nissan S13 model with SR20 engine with standard low mount turbo configuration.

STEP 1: REMOVAL

1. Remove factory intercooler pipes and air intake pipes from turbo side of engine. Ensure to refer to factory service manual.
2. Following factory service manual remove turbo and manifold assembly from vehicle.
 - I. Disassemble the turbo and manifold assembly from the vehicle.
 - II. Ensure to keep all bolts, spacers, gaskets, stock hard lines as these may be required for reinstallation.

STEP 2: ASSEMBLY

1. Install the 7/16-24" to -3AN fitting into top of turbo for turbo oil feed line. On the engine block side of the turbo oil feed line reuse the factory Nissan M12x1.25mm banjo bolt and install on to the stainless-steel banjo to -3an supplied in this kit.
 - I. One extra olive is included in this kit if you wish to change to length of the oil feed line.
 - II. Install oil restrictor into -3AN fitting that connects to banjo fitting on top of turbo when installing oil feed line.
 - III. We recommended to replace all crush washers on banjo bolts to ensure leakage does not occur.
2. Install M14 x 1.5mm to -6AN fittings with new washers supplied into both sides of turbo and into engine block of vehicle.
3. Install water feed line and route line to back of engine. Remove old rubber line and cut braided line to correct length to fit over pipe. Clamp down with hex hose finisher supplied with kit.
 - I. When routing water line ensure it will not interfere with manifold or exhaust of vehicle. Keeping it away from direct contact at all times taking into account engine movement.

STEP 3: INSTALLATION

1. Following factory service manual reinstall turbo and manifold assembly to vehicle.
 - I. Note when installing new braided lines to oil feed and water lines do not overtighten fittings as this will damage them.
2. Reinstall intercooler and air intake piping to vehicle following factory service manual.
3. Start engine and ensure to check for leaks from any fittings or lines before driving vehicle.
4. If no signs of leakage have been found on the final inspection, then the installation is complete.

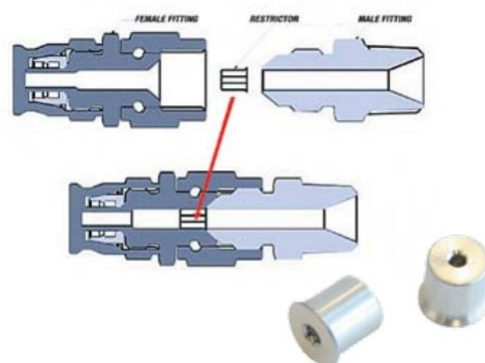

For more information or technical enquires

Contact: Aeroflow Performance on

Phone: (02) 8825 1979 Website: www.aeroflowperformance.com